

NOTES:

1. THIS SURVEY WAS CONDUCTED FROM THE CURRENT DEED OF RECORD AND IS SUBJECT TO ANY INFORMATION WHICH A TITLE SEARCH WOULD REVEAL.
2. THIS SURVEY IS SUBJECT TO ANY EASEMENTS, RIGHTS OF WAYS, AND/OR LEASES WHICH COULD AFFECT THE PROPERTY.

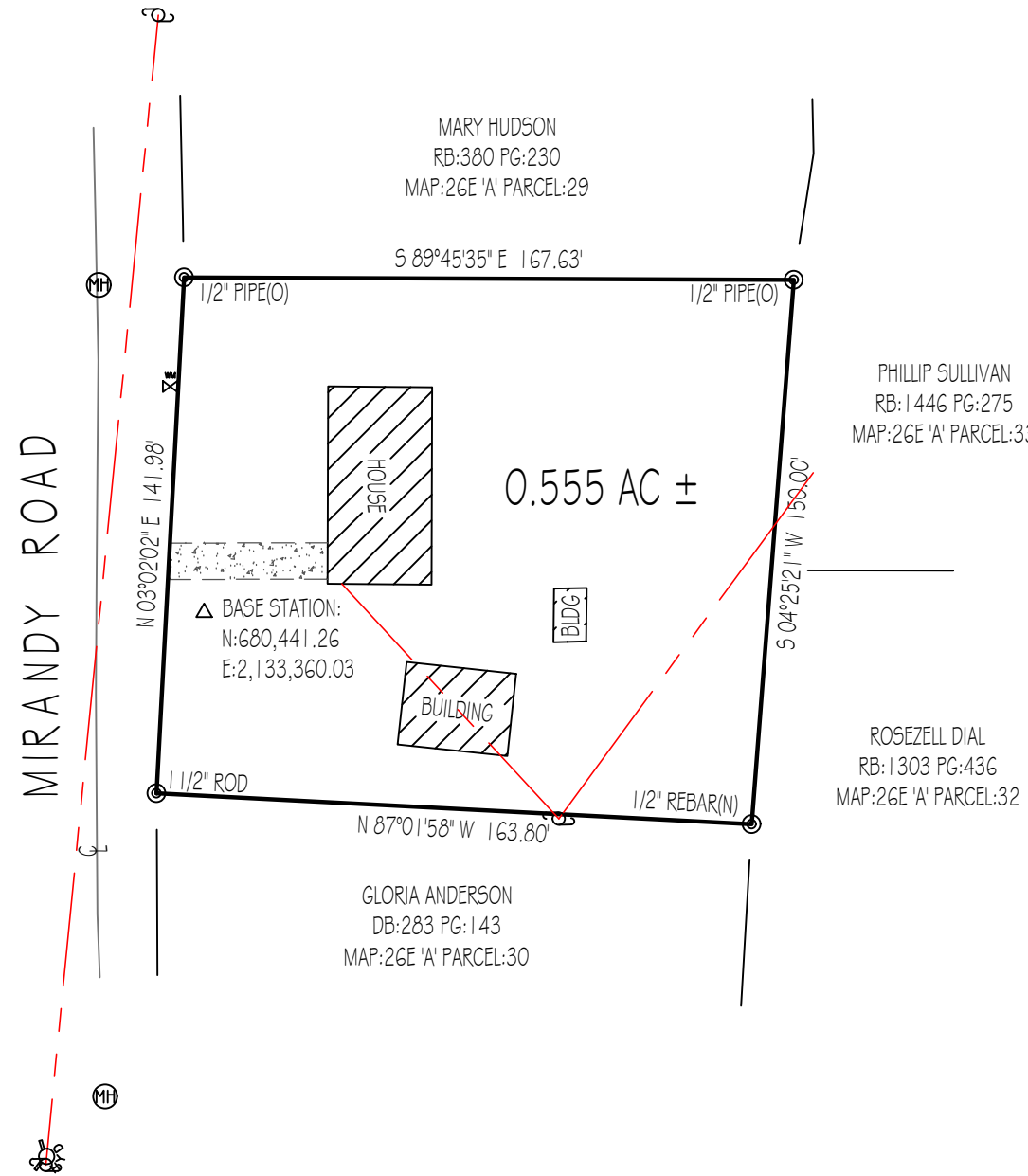
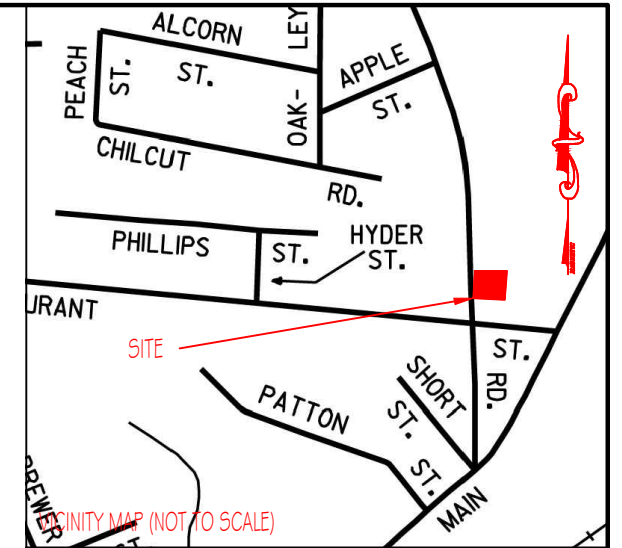

LEGEND

- (N) (NEW)
- (O) (OLD)
- C CENTERLINE
- ⊕ POWER POLE
- X- FENCELINE
- ⊕ FIRE HYDRANT
- ⊕ WATER METER
- ⊕ SANITARY SEWER MANHOLE

GPS CERTIFICATION:

I, ALLEN MAPLES, JR., HEREBY CERTIFY THAT THIS PLAT WAS DRAWN UNDER MY SUPERVISION FROM AN ACTUAL GPS SURVEY MADE UNDER MY SUPERVISION AND THE FOLLOWING INFORMATION WAS USED TO PERFORM THE SURVEY:

A: POSITIONAL ACCURACY - 0.05 FEET
 B: TYPE OF GPS FIELD PROCEDURE - REAL TIME KINEMATIC
 C: DATES OF SURVEY - 05/11/2023
 D: DATUM/EPOCH - NAD83 (2011) / EPOCH: 2010.0000
 E: PUBLISHED/FIXED-CONTROL USE - ASSUMED (AS SHOWN ON PLAT)
 F: GEOID MODEL - GEOID 2018
 G: COMBINED GRID FACTOR(S) - 0.99991891
 H: CONVERGENCE ANGLE - 0°19'38"



Allen Maples
 Land Surveying

38 Mayberry Street
 Sparta, TN 38583
 Phone: (931) 837-5446

JAMES & MARGARET ROBERSON 169 MIRANDY ROAD	
19TH CIVIL DISTRICT	TOTAL ACRES: 0.555 AC ±
PUTNAM COUNTY, TN	SCALE: 1"=50'
P/L DB:258 PG:717	DATE: 05/11/2023
TAX MAP:26E 'A' PARCEL:31	DRAWING: 23-129 A3